



APDS/ARAS – May 6–8, 2025

ASE – May 8-10, 2025

Surgical Education Week | May 6–10, 2025

SHERATON GRAND SEATTLE, WA



SURGICAL EDUCATION WEEK EXHIBITORS

ABSITE Quest

ACS Fundamentals of Surgery Curriculum

American Board of Surgery and SCORE

American College of Surgeons

American College of Surgeons - Division of Education

Applied Medical

ASE Foundation

ATLAS

Caliber Boards

Kern National Network for Flourishing in Medicine

Limbs & Things

Medicus Healthcare Solutions

MyEvaluations.com

Q-Optics

Southmedic

Strategic Operations Medical

Surgical Science

TrueLearn

VirtaMed

Whole Body Optimism

WISE-MD (Surgery) & WISE-OnCall

Learn more about our 2025 Exhibitors here.

THANK YOU TO OUR INDUSTRY PARTNERS AND INSTITUTIONAL MEMBERS

**The ASE thanks the following companies and foundations for their
commercial support of the Annual ASE Meeting**

ABSITE Quest

Sponsor - URiM Trainee Scholarships and Refreshment Breaks

Christopher Brandt, MD and Beth Sersig, MD

Sponsor - Finding Aspiring Surgeons for Tomorrow Community Outreach Event

Johnson & Johnson MedTech

Sponsor - Trainee Lounge/Future Leaders Learning Center

Limbs & Things

Sponsor - ATLAS Competition

SurgWise

Sponsor - Family Care Grants

INSTITUTIONAL ASE MEMBERS

Platinum



Gold



Silver



Surgical Education Week 2025



GENERAL INFORMATION

GENERAL INFORMATION

HOTEL INFORMATION

Sheraton Grand Seattle

1400 6th Avenue, Seattle, WA

206.621.9000

APDS Registration Hours

Located in Grand Ballroom Foyer

Monday 7:00am - 6:00pm

Tuesday 7:00am - 6:30pm

Wednesday 6:30am - 5:30pm

Thursday 6:30am - 12:00pm

ASE Registration Hours

Wednesday 6:30am - 5:30pm & 6:30pm - 7:30pm

Thursday 6:30am - 6:30pm

Friday 6:45pm - 6:30pm

Saturday 6:45am - 11:00am

Exhibit Hall Hours

Located in Grand Ballroom Foyer

Wednesday 9:00am - 4:00pm & 6:30pm - 7:30pm

Thursday 9:00am - 4:00pm

Friday 9:00am - 1:00pm

LOST & FOUND

Located at the Registration Desk

SAFETY AND SECURITY

We take every precaution to ensure the safety and security of our attendees and their guests. However, we urge you to be aware and take simple steps to guard your possessions. Therefore, we suggest the following:

- Do not leave your purse or briefcase unattended
- Do not leave your laptop, phone or personal devices on the floor or out of your sight
- Be aware of your surroundings
- If you do misplace or lose something, please stop by the Registration Desk

Thank you for your help keeping everyone safe.

APDS / ARAS

apds@lp-etc.com | aras@lp-etc.com | 913.402.7102

ASE

meetings@surgicaleducation.com | 310.215.1226

MEETING SPACE

35th Floor - Pike Street Tower

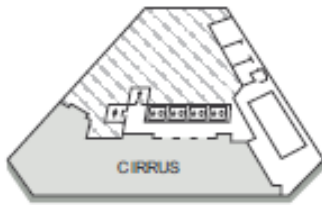

Fourth Floor - Pike Street Tower



Fourth Floor - Union Street Tower

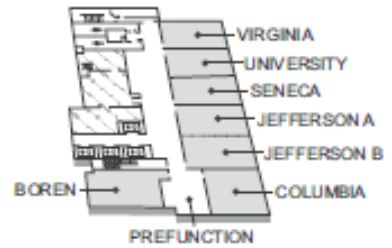

Third Floor

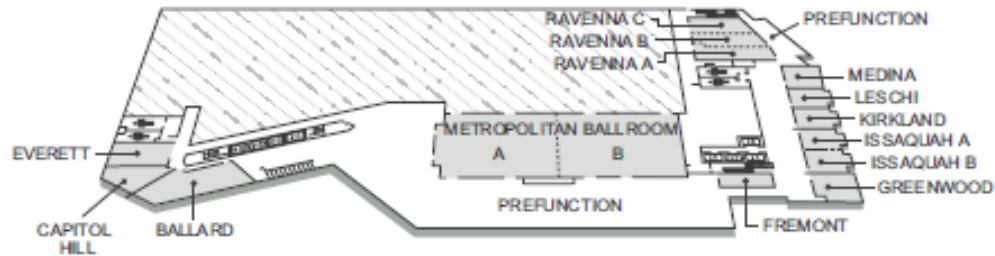

Second Floor

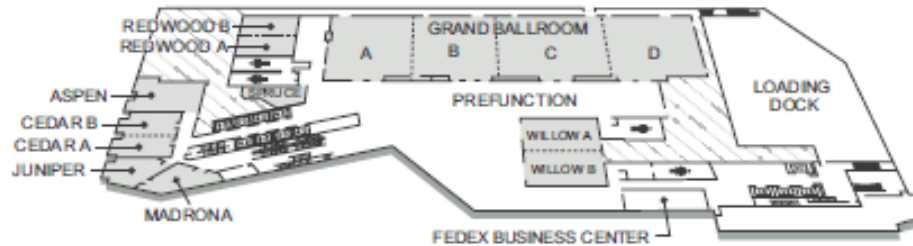

First Floor - Lobby Level

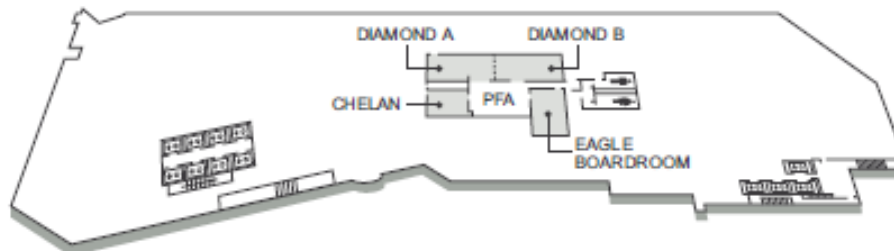



Surgical Education Week 2025

CONTINUING MEDICAL EDUCATION

APDS/ARAS CME Information



CONTINUING MEDICAL EDUCATION CREDIT INFORMATION

Registered APDS/ARAS attendees are eligible to apply for CME credits until June 24, 2025

Claim CME / Certificate of Attendance

CME Accreditation

This activity has been planned and implemented in accordance with the Essential Areas and policies of the Accreditation Council for Continuing Medical Education through the joint providership of PESI Inc. and the Association of Program Directors in Surgery (APDS). PESI Inc. is accredited by the ACCME to provide continuing medical education for physicians.

AMA PRA Designation Statement

The PESI, Inc. designates this live educational activity for a maximum of 34.75 AMA PRA Category 1 Credit(s) . Physicians should only claim credit commensurate with the extent of their participation in the activity.

International CME

International Physicians are formally eligible for AMA PRA Category 1 Credit .

Physician Assistants

AAPA accepts Category 1 credit from AOACCME, Prescribed credit from AAFP, and AMA PRA Category 1 Credit for the PRA from organizations accredited by ACCME.

[View Disclosure Summary](#)

ASE CME Information



ASE 2025 Annual Meeting Accreditation Statement

CONTINUING MEDICAL EDUCATION CREDIT INFORMATION

Accreditation

This activity has been planned and implemented in accordance with the accreditation requirements and policies of the Accreditation Council for Continuing Medical Education (ACCME) through the joint providership of American College of Surgeons and Association for Surgical Education. The American College of Surgeons is accredited by the ACCME to provide continuing medical education for physicians.

AMA PRA Category 1 Credits™

The American College of Surgeons designates this live activity for a maximum of **21.25** AMA PRA Category 1 Credits™. Physicians should claim only the credit commensurate with the extent of their participation in the activity.



ASE 2025 Pre-Meeting Course: Updates on the Surgery Clerkship

CONTINUING MEDICAL EDUCATION CREDIT INFORMATION

Accreditation

This activity has been planned and implemented in accordance with the accreditation requirements and policies of the Accreditation Council for Continuing Medical Education (ACCME) through the joint providership of American College of Surgeons and Association for Surgical Education. The American College of Surgeons is accredited by the ACCME to provide continuing medical education for physicians.

AMA PRA Category 1 Credits™

The American College of Surgeons designates this live activity for a maximum of **8** AMA PRA Category 1 Credits™. Physicians should claim only the credit commensurate with the extent of their participation in the activity.



ASE CME Information



In accordance with the ACCME Accreditation Criteria, the American College of Surgeons must ensure that anyone in a position to control the content of the educational activity (planners and speakers/authors/discussants/moderators) has disclosed all financial relationships with any commercial interest (termed by the ACCME as “ineligible companies”, defined below) held in the last 24 months (see below for definitions). Please note that first authors were required to collect and submit disclosure information on behalf all other authors/contributors, if applicable.

Ineligible Company: The ACCME defines an “ineligible company” as any entity producing, marketing, re-selling, or distributing health care goods or services used on or consumed by patients. Providers of clinical services directly to patients are NOT included in this definition.

Financial Relationships: Relationships in which the individual benefits by receiving a salary, royalty, intellectual property rights, consulting fee, honoraria, ownership interest (e.g., stocks, stock options or other ownership interest, excluding diversified mutual funds), or other financial benefit. Financial benefits are usually associated with roles such as employment, management position, independent contractor (including contracted research), consulting, speaking and teaching, membership on advisory committees or review panels, board membership, and other activities from which remuneration is received, or expected.

Conflict of Interest: Circumstances create a conflict of interest when an individual has an opportunity to affect CME content about products or services of an ineligible company with which he/she has a financial relationship.

The ACCME also requires that ACS manage any reported conflict and eliminate the potential for bias during the educational activity. Any conflicts noted below have been managed to our satisfaction. The disclosure information is intended to identify any commercial relationships and allow learners to form their own judgments. However, if you perceive a bias during the educational activity, please report it on the evaluation.

ASE DISCLOSURE LISTS

Please click the links below to view the complete disclosure insert list.

[Annual Meeting](#)

[Pre-Meeting Course: Updates on the Surgery Clerkship](#)

Evaluation pages can be found below. Claiming links for ASE 2025 will become available at the end of the meeting. Once open, the deadline to claim CME credits for ASE 2025 will be Thursday July 3, 2025.

[Annual Meeting CME](#)

[Pre-Meeting Course: Updates on the Surgery Clerkship CME](#)

Surgical Education Week 2025



LEADERSHIP

APDS/ARAS LEADERSHIP

APDS Officers

President	Jennifer Choi MD
President-Elect	Valentine Nfonsam MD, MS
Secretary	Kari Rosenkranz MD
Treasurer	Jonathan Dort MD
Immediate Past President	Amit Joshi MD

Executive Committee

Cary Arons MD
Sebastiano Cassaro MD
Paul Wise MD (Program Chair)

APDS Board of Directors

Constance Cashen DO
Charles Friel MD
Diane Hale MD
Jason Kempenich MD
Jennifer LaFemina MD
Joon Shim MD, MPH
Rahul Anand MD
Marcie Feinman MD
Wade Douglas MD
Kareem Abdelfattah MD
Daniel Relles MD
Mike Truitt MD



ARAS Executive Committee

President	Kylene Smartis C-TAGME
President-Elect/Membership	Mary Ann Garcia-Bowerman MBA, C-TAGME
Secretary	Dana Cooley C-TAGME
Membership	Stephanie Chairs C-TAGME
Immediate Past President	Hemali Shah C-TAGME, PACE
Advisor	Brianne Nickel MD, C-TAGME
Prof Development/ Research Social & Program Program	Melissa Molina MBA, C-TAGME Janice Hutchison C-TAGME Tyronda Rogers BBA





ASE LEADERSHIP 2024-2025

ASE Board of Directors

President

Mohsen Shabahang,
MD, PhD, MAMSE

President-Elect

Aimee Gardner, PhD

Vice President

Marc de Moya, MD

Secretary/Vice Chair, Finance

Tracey Dechert, MD

Treasurer/Chair, Finance

Alan Harzman, MD

Past President

Michael Awad,
MD, PhD, MHPE

Past President/Editor- in-Chief, GSEJ-JASE

Dimitrios Stefanidis,
MD, PhD

Past President

Adnan Alseidi,
MD, EdM

ASE Foundation President

Amalia Cochran, MD

Chair, Assessment, Curriculum, and Evaluation

Emily Huang,
MD, MAEd

Vice Chair, Assessment, Curriculum, and Evaluation

Tasha Posid, MA, PhD

Chair, Awards

Cate Unruh, MEd

Vice Chair, Awards

Phoenix (Xiaodong)
Chen, PhD, MSc, Beng

Chair, Citizenship and Global Responsibility

Sabrina Sanchez,
MD, MPH

Vice Chair, Citizenship and Global Responsibility

Olabisi Sheppard, MD

Chair, Clerkship Directors

Matthew Lin, MD

Vice Chair, Clerkship Directors

Justin Wagner, MD

Chair, Communications

Ming-Li Wang, MD

Vice Chair, Communications

John Falcone, MD, MS

Chair, Coordinators of Surgical Education

Rolanda Whitford,
APACS

Vice Chair, Coordinators of Surgical Education

Caroline Rhodes,
APACS

Chair, Development

Dmitry Nepomnayshy,
MD

Vice Chair, Development

Nell Maloney Patel, MD

Chair, Diversity, Equity, and Inclusion

Amanda Cooper, MD

Vice Chair, Diversity, Equity, and Inclusion

Sheina Theodore, MD

Chair, Faculty Development

Kenneth Lipshy, MD

Vice Chair, Faculty Development

Jacob Peschman, MD

Chair, Graduate Surgical Education and Member-at-Large

Kimberly
Hendershot, MD

Vice Chair, Graduate Surgical Education

Kshama Jaiswal, MD

Chair, Membership

Prasad Poola, MD

Vice Chair, Membership

Sarah Jung, PhD

Chair, Program

Nabil Issa, MD

Vice Chair, Program

Brigitte Smith,
MD, MHPE

Chair, Simulation and Member-at-Large

Joon Shim, MD, MPH

Vice Chair, Simulation

Matthew Ritter, MD

Chair, Surgical Education Research

Priti Parikh, PhD

Vice Chair, Surgical Education Research

Hee Soo Jung, MD

Chair, Vice Chair of Education

Brigitte Smith,
MD, MHPE

Vice Chair, Vice Chair of Education

Rebecca Hoffman, MD

Resident Chair, Trainee

Sophia Williams-
Perez, MD

Medical Student Chair, Trainee

Alexandria L. Soto

Resident Vice Chair, Trainee

Steven Thornton, MD

Medical Student Vice Chair, Trainee

Mikayla Deckard

CoSEF Representative

Caitlin Silvestri, MD

SELF Program Director

Laura Torbeck, PhD, MS

SERF Program Director

Gurjit Sandhu, PhD

SERF Program Co-Director

David Rogers, MD

Member-at-Large

Alan Ladd, MD

ACS Senior Vice President, Division of Education

Ajit K. Sachdeva, MD

ACS Board of Governors Representative

Christopher Brandt, MD

Liaison – Alliance for Clinical Education

Rachel Slotcavage, MD

Liaison – APDS

Tania Arora, MD

Liaison – WISE-MD

Mary Ann Hopkins, MD

Liaison – ACS/APDS/ ASE Prep Curriculum

Kristine Calhoun, MD

Liaison – ACS/ ASE Medical Student Core Curriculum

Ranjan Sudan, MD

ASE Executive Director

Yumi Hori

ASE Program Committee

Program Chair

Nabil Issa, MD

Vice-Chair/Panel Chair

Brigitte Smith,
MD, MHPE

2nd Vice-Chair

Megan Miller, MD

3rd Vice Chair

Jeremy Lipman, MD,
MHPE, FASCRC

President

Mohsen Shabahang,
MD, PhD, MAMSE

President-Elect

Aimee Gardner, PhD

ASE Foundation President

Amalia Cochran, MD

Assessment, Curriculum, & Evaluation Committee Chair

Emily Huang,
MD, MAEd

Awards Committee Chair

Cate Unruh, MEd

Citizenship and Global Responsibility Committee Chair

Sabrina Sanchez,
MD, MPH

Clerkship Directors Committee Chair

Matthew Lin, MD

Coordinators Committee Chair

Rolanda Whitford,
APACS

Development Committee Chair

Dmitry Nepomnayshy,
MD

Diversity, Equity, and Inclusion Committee Representative

Lindsay Kranker, MD

Recorder

Abbey Fingeret,
MD, MHPTT

Recorder

Ross Willis, PhD

Surgical Education Research Committee Chair

Priti Parikh, PhD

Trainee Committee Representative

Joe L'Huillier, MD

Surgical Education Week 2025



KEYNOTE SPEAKERS



APDS Presidential Address



Jennifer Choi MD
Indiana University School of Medicine

The Presidential Address
Wednesday, May 7, 2025
10:45am – 11:45am

Dr. Jennifer Choi currently serves as Associate Dean of Graduate Medical Education and Professor of Clinical Surgery. Dr. Choi received her medical degree from Indiana University School of Medicine where she also completed her General Surgery residency and a fellowship in Minimally Invasive and Bariatric Surgery.

Her clinical focus is minimally invasive surgery and includes bariatric surgery, gastroesophageal reflux disease, hiatal hernias, and all types of abdominal wall hernias.

Dr. Choi's research focus is surgical education and bariatric surgery. She has co-authored more than 30 peer-reviewed publications.

Dr. Choi is a member of the American College of Surgeons (ACS), SAGES, the Association of Program Directors in Surgery (APDS) and Association of Surgical Education. She currently serves as the President of APDS and on multiple education related committees of the ACS.

APDS Keynote Lecture



Jerome Adams MD, MPH
Purdue University and 20th U.S. Surgeon General

Leadership in Turbulent Times
Thursday, May 8, 2025
9:30am – 10:45am

Presidential Fellow, Executive Director of the Center for Community Health Enhancement and Learning (HEAL), and Distinguished Professor of Practice

Dr. Jerome Adams was appointed as a Presidential Fellow and the Executive Director of the Center for Community Health Enhancement and Learning (HEAL) on October 1, 2021. He is also a Distinguished Professor of Practice in the departments of Pharmacy Practice and Public Health.

As the 20th U.S. Surgeon General and a prior member of the President's Coronavirus task force, Dr. Adams has been at the forefront of America's most pressing health challenges. A regular communicator via tv, radio, and in print, Dr. Adams is an expert not just in the science, but also in communicating the science to the lay public, and making it relevant to various audiences.

Dr. Adams is a licensed anesthesiologist with a master's degree in public health, and ran the Indiana State Department of Health prior to becoming Surgeon General. In the State Health Commissioner role he managed a \$350 million dollar budget and over 1000 employees, and led Indiana's response to Ebola, Zika, and HIV crises. Notably, Dr. Adams helped convince the Governor and State Legislature to legalize syringe service programs in the state, and to prioritize \$13 million in funding to combat infant mortality. As Surgeon General, Dr. Adams was the operational head of the 6000 person Public Health Service Commissioned Corps, and oversaw responses to 3 back to back category 5 hurricanes, and to a once in a century pandemic.

In addition to his recent COVID19 work, Dr. Adams has partnered with and assisted organizations as they navigate the opioid epidemic, maternal health, rising rates of chronic disease, the impacts of rising suicide rates in our Nation, and how businesses can become better stewards and stakeholders in promoting community health.

ASE Keynote Speakers



J. ROLAND FOLSE LECTURE

Thursday, May 8, 2025 | 1:55PM - 2:55PM

Patricia Joy Numann, MD

Patricia Joy Numann, MD, completed her surgical training at the State University of New York Upstate Medical Center in 1970, when few women became surgeons. She spent her entire academic career at her alma mater, retiring in 2007 as the Lloyd S. Rogers Professor of Surgery. Specializing in breast and endocrine surgery, Dr. Numann established the region's first Comprehensive Breast Care Center in 1986. Her dedication to breast cancer research helped inspire the creation of the Breast Cancer Research Foundation, which has raised over \$3 million since 2001. Dr. Numann was also a leader in surgical education, serving as President of the Association for Surgical Education and creating the ACS Fundamentals of Surgery Curriculum. A staunch advocate for gender equity, she co-founded the Association of Women Surgeons in 1981. Her activism and leadership earned her numerous accolades, including the ACS Lifetime Achievement Award in 2019 and honorary membership from the Association of Surgeons of India.



ROYCE LAYCOCK LECTURE

Friday, May 9, 2025 | 1:00PM - 2:00PM

Amer Kaissi, PhD, *Trinity University*

Amer Kaissi, PhD, is an-award winning Professor of Leadership. He is an executive coach that has worked with hundreds of leaders and teams all over the world. Amer is the author of three books. His most recent book is "Humbitious: the power of low-ego, high-drive leadership." He has been featured on the Harvard Business Review podcast and numerous other media outlets. He has spoken on leadership topics at more than 250 organizations and professional conferences. He lives in San Antonio with his wife and two teenagers.

ASE Keynote Speakers



PRESIDENTIAL ADDRESS

Friday, May 9, 2025 | 8:10AM - 9:10AM

Mohsen Shabahang, MD, PhD, MAMSE, *WellSpan Health*

Dr. Mo Shabahang is the President of the Association for Surgical Education. He has spent his career as a Surgical Oncologist, surgical educator (Program Director for 16 years), and healthcare executive. He obtained most of his training at Georgetown University Medical Center and completed his Surgical Oncology fellowship at University of Miami. Subsequently, he has been at Baylor Scott & White, Geisinger, and Wellspan Health.



KEYNOTE LECTURE

Friday, May 9, 2025 | 12:25PM - 12:55PM

Olle Ten Cate, PhD, *University Medical Center Utrecht*

Olle ten Cate, PhD, is an emeritus Professor of Medical Education at University Medical Center Utrecht and a 2024-25 Visiting Professor at UCSF. Over four decades, he contributed to curriculum innovation, educational research, and faculty development in health professions education globally. He founded the Center for Research and Development of Education at UMC Utrecht and has published 450+ papers, mentored 25 PhD students, and received numerous awards. His interests include competency-based education, particularly in entrustable professional activities and entrustment decision-making.

Surgical Education Week 2025



APDS SCHEDULE



Tuesday, May 6

Willow AB

8:00am - 10:00am

Program Directors Workshop - Day 2

10:00am - 12:00pm

Willow AB

Administrative Chief Resident Workshop

12:00pm - 12:15pm

Grand Ballroom ABC

Opening of APDS Meeting

Jennifer Choi MD | Indiana University School of Medicine

Paul Wise MD | Washington University School of Medicine St. Louis

12:15pm - 1:30pm

Grand Ballroom ABC

Curriculum Development and Implementation

Moderator(s):

Rahul Anand MD | Virginia Commonwealth University Health System Program

Tiffany Tanner MD | University of Nebraska Medical Center

Leadership/Professionalism

Cynthia Talley MD | Medical University of South Carolina Program

Ethics

Piroska Kopar MD, MBA | Washington University, St. Louis

Cultural Dexterity/Health Equity

Gezzer Ortega MD, MPH | Brigham and Women's Hospital

Teaching

Lisa Cunningham MD | The Ohio State University Wexner Medical Center

1:30pm - 2:45pm

Grand Ballroom ABC

APDS Paper Session I - Recruitment

Moderators:

Cary Aarons MD, MEd | Columbia University Irving Medical Center

Devi Mukkai Krishnamurthy MBBS | University of Utah Health

1. The Use of Complex Performance When Considering DO Applicants To General Surgery Residency Programs

Grace Young DO | Cleveland Clinic Foundation

2. Evaluating the Impact of Anti-DEI Legislation on General Surgery Residency Program Websites

Taylor Carter MD | University of North Carolina - Chapel Hill

3. Situational Judgment Tests Offer An Unbiased & Effective Tool To Assess Competencies In Applicants

Usman Panni MD | Washington University in St. Louis

4. Program Signaling in Surgical Residency Recruitment: Applicant Perspectives at a Single Institution

Samantha Lai BA | Columbia University Vagelos College of Physicians and Surgeons

5. Use and Impact of Preference Signaling in the General Surgery Residency Application Process

Pooja Varman MD, MS | Cleveland Clinic Foundation

6. Artificial Intelligence-Assisted Narratives: Analysis of Surgical Residency Personal Statements

Oswaldo Subillaga MD | Baystate Medical Center

2:50pm - 3:00pm

Grand Ballroom Pre-Function

Afternoon Break

3:00pm - 4:15pm
Grand Ballroom ABC

Alphabet Soup

Moderators:

Jennifer Preston MD | University of Arizona College of Medicine-Phoenix Program

Jennifer LaFemina MD | University of Massachusetts Chan Medical School

NRMP (National Resident Matching Program)

Donna Lamb DHSc, MBA, BSN

ERAS (Electronic Residency Application Service)

Patrick Fritz

ACGME (Accreditation Council for Graduate Medical Education)

Stephanie Heller MD

ABS (American Board of Surgery)

Karen Brasel MD, MPH

4:15pm - 5:30pm

Grand Ballroom ABC

APDS Paper Session II - Beyond Training: "Products" and Impacts

Moderators:

Laura Brown MD, PhD | University of Illinois College of Medicine Peoria/OSF Healthcare

Jasmeet Paul MD | University of New Mexico School of Medicine Program

7. Understanding Program Level Variation in ACGME Milestones 2.0 Ratings through Intraclass Correlation Analysis

Claire Ferguson MD, Shaghayegh Sabbaghan Kermani MD, Jonah D. Thomas MD, MS

Mass General Brigham/Massachusetts General Hospital

8. Multi-Center Evaluation of Education Outcomes of Graduates from Accredited HBCU Surgery Programs

Cassie Bowers BS | Howard University

9. Perceptions of Flexibility in Surgical Training: A National Survey of Fellowship Program Directors

Steven Tohmasi MD, MPH | Washington University in St. Louis

10. Fellowships after General Surgery Training: Does it Pay?

Jack Donaghue | Dartmouth-Hitchcock/Mary Hitchcock Memorial Hospital Program

11. Does Residency Match Rank Order Predict Graduate Surgery Resident Performance?

Frank Wood MD | University of Oklahoma

5:30pm - 6:45pm

Grand Ballroom Pre-Function

APDS ePoster Sessions

APDS ePoster Session 1

Moderators:

Ramanathan Seshadri MD | Danbury Hospital Program/CT branch campus UVM LCOM

Jocelyn Hunter Rose MD | University of Kansas Medical Center

P1. Structured Mock Oral Examinations as a Learning Tool

Jenny Guido MD | University of South Dakota Sanford

P2. Intern Bootcamp Makeover: The Successful Implementation of a Resident-Driven Curriculum Initiative

Michael Furey DO, MSMED | Geisinger Wyoming Valley Hospital

P3. Implementing Robotic Surgery Training for Residents at an Academic Conference: A Feasibility Study

Chase Marso MD | Mass General Brigham/Massachusetts General Hospital

P4. Does Case Complexity Impact EPA Entrustment? Analysis Across PGY Levels and Phases of Care

Martin Jones | University of Alabama at Birmingham

P5. Objective Evaluation of the Quality of General Surgery Entrustable Professional Activities

Stephanie Seale MD | Stanford University

P6. Resident Contributions to Maturing on Clinical Clerkships: Medical Student Perspectives

Halen Turner MD | Medical College of Wisconsin

P7. Microassessments Generating Insight on Competence (MAGIC) Pilot: A New Resident Assessment Approach

Rachael Acker MD | University of Pennsylvania

P8. Setting Standards for a Foundational Oral Exam within a Competency-Based Program of Assessment

Noosha Deravi MD | Indiana University School of Medicine

P9. Beyond the Numbers: A Closer Look at Patient Census as a Marker of Workload and its Clinical Impact

Christine Wu MD, MMSC | Brigham and Women's Hospital

P10. Comparison of Faculty Evaluations by Residents Individually, in Groups and Faculty Self-Evaluations

Kara Button DO | Maine Medical Center

ePoster Session 2

Moderators:

Kristina Booth MD | University of Oklahoma Health Sciences Center

Stephen Hersperger MD | Orlando Health

P11. Barriers to Adoption of Laparoscopic Surgery in Nigeria Among Surgeons who Underwent Training

Andrea Orji | University of Michigan

P12. Do PGY-1s Always Score a '1'? Variability in Faculty Entrustment Ratings

Julia Kasmirski MD | University of Alabama at Birmingham

P13. Comparison of Executive Functions between Categorical and Preliminary General Surgery Interns

Nicholas Anton MS | Indiana University School of Medicine

P14. Assessing Retention in Vascular Shunt Placement among General Surgery Residents: A Swine Model Study

Anna Rogalska DO | Brooke Army Medical Center

P15. Evaluation of a Structured Peer Feedback Program in General Surgery Residency; A Mixed Methods Study

Mckenzie Rowe MD | Inova Health System

P16. Parental Leave Policies and Resources during General Surgical Residency—Are we ACGME-Compliant?

Claire Perez MD | Cedars-Sinai Medical Center

P17. A Peer-Onsite-Distance Mentorship Model for Underrepresented Minority Residents in General Surgery

Ilan Layman MD | Brown University

P18. General Surgery Residents as Teachers to Medical Students or Something More? A Qualitative Analysis

Ariana Naaseh MD, MPHS | Washington University in St. Louis

P19. Finding Meaning in Your Program Surveys: A Mixed Methods Case Study Design for Program Improvement

Shawn Moore EdD | East Carolina University

P20. Integrating a Health Equity Curriculum for General Surgery Residents: A Mixed-Methods Study

Ariana Naaseh MD, MPHS | Washington University in St. Louis

ePoster Session 3

Moderators:

Marcela Ramirez MD | HCA Healthcare: East Florida Division GME: Kendall Regional

Frank Wood MD | University of Oklahoma Health Sciences Center

P21. Improving Case Logging Efficiency in General Surgery Residency with Smartphone App

Tamara Damrel MD | Memorial Healthcare System

P22. An Analysis of Three-Year Medical School Pathway Student Performance in General Surgery Residency

Alexis Korman MD | NYU Langone Health

P23. The Application of a Protocol for Virtual Certifying Examinations: Five-Year Results (2020-2024)

James Rucinski MD | University of Vermont

P24. Multi-Disciplinary, Simulation-Based Massive Transfusion Protocol Curriculum

Gabrielle Moore MD | Medical College of Georgia

P25. Better the Surgeon You Know: Trainee Familiarity with Faculty Promotes Intraoperative Entrustment

Alexandra Theall | University of Michigan

P26. Benefits of a Novel Multidisciplinary Program to Support Non-designated Surgical Residents

Rachel Sachs MD | Rutgers University

P27. Feasibility of Using AI to Evaluate General Surgery Residency Application Personal Statements

Pooja Varman MD, MS | Cleveland Clinic Foundation

P28. Senior Surgery Residents Assessment of Candidates for General Surgery Residency Positions

Deirdre Sheets DO | Western Michigan University Homer Stryker M.D. School of Medicine

P29. Developing a Resident Mentorship Program: Preliminary Results of a Quality Improvement Analysis

Andrew Vogel | Alabama College of Osteopathic Medicine

P30. Prevalence and Risk Factors of Moral Distress Among Surgeons Specialized in Oncology Care

Jennifer Chen MD | The University of Texas MD Anderson Cancer Center

ePoster Session 4

Moderators:

Omar Llaguna MD | Memorial Healthcare System

Areti Tillou MD | UCLA

P31. Leveraging NLP for Automated Assessment of Surgical Resident Operative Notes

Philip Jenkins MD | Oregon Health and Science University

P32. Does Undergraduate Medical Institution Predict Future Surgical Leadership?

Maya Hunt MD | Indiana University School of Medicine

P33. Surgeons in Hospital Leadership Positions across the United States: A Descriptive Analysis

Grace Kuroki | Main Line Health System/Lankenau Medical Center

P34. Preference Signaling for Residency Application: A Process in Evolution

Subhasis Misra MD | BayCare Health System

P35. Multi-Center Analysis of Preliminary Surgery Resident Career Paths in Minority Serving Institutions

Meave Otieno MD, MS | Howard University

P36. Using Implementation Science to increase faculty engagement with Entrustable Professional Activities

Carolyn Hu | Northwestern University

P37. Robotic March Madness: Gamification of Robotic Surgical Simulation Results in Hyper-performance

Shannon Barter MD | Duke University

P38. Impact of Program Signaling Change from 5 to 15 on Surgery Residency Interview Invitations

Kindha Nasef MD | Howard University

P39. Superficial Temporal Artery Pseudoaneurysm After Blunt Trauma

Rosmeld Castillo MD | University of Illinois Chicago

P40. Defining Non-Physician Duties in Surgery: The Resident Perspective

Manuel Castillo-Angeles MD, MPH | Brigham and Women's Hospital

ePoster Session 5

Moderators:

Charles Paget MD | Virginia Tech Carilion

Jeanette Zhang MD | Tulane University

P41. SEW Much for That: Publication Rate Among Presentations at Surgical Education Week

Lauren Sands | University of Maryland

P42. Beyond Tradition: The Value of Peer Letters in Holistic Review of Surgery Residency Applications

Caitlin Silvestri MD | New York Presbyterian Hospital (Columbia Campus)

P43. Preference of Surgery Applicant Interview Modality at an Independent Academic Medical Center

Courtney Whitelock MD | University of Michigan Health - Sparrow

P44. Senior Surgery Residents Assessment of Junior Residents on ACGME Milestones

Deirdre Sheets DO | Western Michigan University School of Medicine

P45. Standardized Assessment Tool for Surgery Applicants Reduces Attrition and Improves Board Pass Rate

Ravi Radhakrishnan MD, MBA | University of Texas Medical Branch at Galveston

P46. Enhancing Resident Proficiency in Robotic Partial Gastrectomy: A Multi-institutional Study

Connie Gan MD | Stanford University

P47. Implementing a Robotic Surgery Training Program (RoSTraP) Utilizing a Live Swine Model

Gabrielle Falco MD | Brooke Army Medical Center

P48. Categorical Positions in General Surgery Outside the NRMP: Preliminary Results

Ahmed Elkamel MBBS | University of Arizona

P49. "Worried About Managing It All": Curriculum Impact on Surgical Residents' Transition to Senior Roles

Irene Zhang MD, MPH | Massachusetts General Hospital

ePoster Session 6

Moderators:

Benjamin Ferguson MD, PhD | University of Michigan, Ann Arbor

Stephanie Scott MD | University of Tennessee Medical Center- Knoxville

P50. The Virtuous Surgeon Redux: Applicant Perspectives on What Makes a Good Surgeon

Jonathan D'Angelo PhD, MA | Mayo Clinic College of Medicine and Science (Rochester)

P51. Presence of Outcome Bias Among General Surgery Residents

Darian Hoagland MD | Lahey Hospital and Medical Center

P52. Leadership Potential Unlocked: Insights From a Leadership Coaching Program for Chief Residents

Christine Wu MD, MMSC | Brigham and Women's Hospital

P53. Correlation of American Board of Surgery In-Training Exam Metrics in a Post Percentile Reporting Era

Tyler Arscott MD | Henry Ford Health/Henry Ford Jackson Hospital

P54. Advanced Surgical Skills Utilizing High-Fidelity Dynamic Animal-Lab Modules is Desired by Residents

Clayton Wyland DO | Western Michigan University School of Medicine

P55. Artificial Intelligence Assisted Selection of General Surgery Residency Candidates

Savitha Baragada DO | MercyOne Des Moines Medical Center

P56. When Can They Be Trusted? Standard Setting w/ EPAs for the Competent Foundational Surgical Resident

Maya Hunt MD | Indiana University School of Medicine

P57. Career Outcomes and Trajectory of NIH T32 Training Grant Graduates

Jennifer Chen MD | The University of Texas MD Anderson Cancer Center

P58. Identifying the Top Priorities of Underrepresented Minority Applicants' Applying to Surgery Programs

Alexandria Soto | Duke University

ePoster Session 7

Moderators:

Jacob Edwards MD | University of Tennessee Medical Center at Knoxville

Louise Yeung MD | Kaiser Permanente Southern California (Los Angeles)

P59. The Surgical Resident Experience with Patients and Team Members: A Prospective Observational Study

Anna Newcomb PhD, MSW, LCSW | Inova Health System

P60. Using Machine Learning to Assess Feedback Quality for Medical Students in their Surgery Clerkship

Lauren Weaver MD | University of Minnesota

P61. Analysis of General Surgery Residency Program Directors' Subspecialties across the United States

Grace Kuroki | Main Line Health System/Lankenau Medical Center

P62. Program-Weighted Situational Judgement Tests: Making Holistic Review Evidence Based and Manageable

Noosha Deravi MD | Indiana University School of Medicine

P63. Implementing an International Mock Oral Examination Collaborative

Jessica Zaman MD | Albany Medical College

P64. Resident Confidence in Robotics Versus Laparoscopic Surgery

Leyann Dahlgren MD | Ochsner Clinic Foundation

P65. Faculty Reciprocal Peer Coaching: A Feasibility Study of Simulation Among Colorectal Surgery Faculty

Shannon Barter MD | Duke University

P66. Development of a Comprehensive Multidisciplinary Simulation Curriculum at a Single Institution

Austin Graf MD | Medical College of Georgia

P67. The Surgical ICU Bootcamp: An Introduction and Refresher of Surgical Critical Care

Salmaan Zafer MD | Geisinger Wyoming Valley Medical Center

P68. Inclusion of Healthcare Disparities in Morbidity and Mortality Conference

Austin Carmack MD, MS | Robert Packer Hospital/Guthrie

P69. Trauma Education: Investigating multi-modality Approaches in Clinical Reasoning

Vincent Alexander | Alabama College of Osteopathic Medicine

6:00pm - 7:00pm

APDS & ARAS Reception

Grand Ballroom Pre-Function

Wednesday, May 7

7:00am - 7:50am

Grand Ballroom ABC

APDS Panel: Breakfast with the Experts - Practical Considerations for Programs/PDs

Moderator(s):

Marcie Feinman MD | Sinai Hospital of Baltimore Program

Jason Lees MD | University of Oklahoma College of Medicine

EPAs for Certification

Karen Brasel MD, MPH | American Board of Surgery

ACS

Patrice Gabler Blair DrPH, MPH | American College of Surgeons

SECOND / THIRD

Yue-Yung Hu MD, MPH | McGaw Medical Center of Northwestern University Program

ECFMG

Eric Holmboe MD | Intealth

8:00am - 9:15am

Grand Ballroom ABC

APDS Panel: Struggling Learners: Remediation and Beyond

Moderators:

Nitin Mishra MBBS, MS, MPH | Mayo Clinic

Ajita Prabhu MD | Cleveland Clinic

Programmatic Approach to the Struggling Learner

Marcie Feinman MD, MEHP | Sinai Hospital of Baltimore Program

Impairment and Performance

Kari Rosenkranz MD | Dartmouth-Hitchcock/Mary Hitchcock Memorial Hospital Program

The Appeals Process and Post-Remediation: When They Return (or Want to Return)

Jeremy Lipman MD, MHPE | Cleveland Clinic

2nd Victim Phenomenon: The Impact of Remediation on Educators

Betsy Williams PhD, MPH | Professional Renewal Center

9:15am - 10:30am

Grand Ballroom ABC

APDS Paper Session III - EPAs

Moderators:

Chadi Abouassaly MD | MedStar Health/Georgetown/Washington Hospital Center

Jade Gallimore DO, MBA | Charleston Area Medical Center

12. Not All EPAs are Created Equal: Fixing Sampling Bias with Utility Modeling

Philip Jenkins MD | Oregon Health and Science University

13. Comparing High and Low EPA Assessment Completers: Insights to improve EPA implementation

Alyssa Murillo MD, MS, MA.Ed | University of California San Francisco

14. Shared EPA Expectations – Grounding EPAs into a Traditional Time-Based Rotational Training Paradigm

Shannon Barter MD | Duke University

15. Experience with Entrustable Professional Activities During the Year of Progressive Engagement

Karen Brasel MD, MPH | American Board of Surgery

16. Factors Influencing Dictated Feedback on Resident Operative Performance: Insights from SIMPL App

Madeline Cloonan MD | University of Nebraska Medical Center

17. Multi-Institutional Analysis of ENTRUST Performance with Competency-Based Surgical Education Metrics

Nathan Lam BA | Stanford University

10:30am - 10:45am

Grand Ballroom Pre-Function

Morning Break

10:45am - 11:45am

Grand Ballroom ABC

APDS Presidential Address

Introduction: Valentine Nfonsam MD, MS | Morehouse School of Medicine

The Presidential Address

Jennifer Choi MD | Indiana University School of Medicine

11:45am - 12:00pm

Grand Ballroom Pre-Function

Box Lunch Pick-Up

12:00pm - 12:45pm

APDS Workshops - Round 1

(listed in alpha order by workshop title)

Jefferson, 4th Floor

Advancing Holistic Review Strategies in Residency Program Recruitment

Formosa Chen MD | UCLA

Seneca, 4th Floor

ATLAS-Advanced Training in Laparoscopic Suturing Curriculum Workshop

Nicholas Jonas MD | Banner Health

University, 4th Floor

Developing Research With Limited Resources - How We Did It

Gopal Kowdley MD | Tidal Health MD

Redwood, 2nd Floor

How to Start a Resident Peer Coaching Program

Douglas Smink MD, MPH | Brigham and Women's Hospital

Jamie Hillas MD | Brigham and Women's Hospital

Stefanie Soelling MD, MPH | Brigham and Women's Hospital

Virginia, 4th Floor

Implementation Science 101 for Surgical Educators

Rebecca Williams MD | Northwestern Medicine

Diamond, 1st Floor

Medical Economics Workshop

Ebondo Mpinga MD | Wellspan

Boren, 4th Floor

Partnering for Success: The PD-PC Dynamic

Jennifer Yu, MD, MPHS | Washington University School of Medicine, St. Louis

Christa Donald MA | Washington University School of Medicine, St. Louis

Ravenna, 3rd Floor

Revamping Your Clinical Competency Committee-CCC

John Gahagan MD | Stanford University

Cedar, 2nd Floor

The PsychoSurgical Learning Environment: Tips for the Practical Application of Key Psychological Concepts in Surgical Training

Rebecca Hoffman MD | Geisinger

Ballard, 3rd Floor

The Rest of the Story: Perspectives of the Host Institutions in Global Surgery Partnerships (Ballard)

Rondi Kauffmann MD | Vanderbilt University Medical Center

1:00pm - 1:45pm

APDS Workshops - Round 2

(listed in alpha order by workshop title)

Virginia, 4th Floor

Bridging the Gap: Enhancing APP and Resident Collaboration in Surgical Training

Usman Panni MD | Washington University School of Medicine, St. Louis

University, 4th Floor

Disaster Planning

Adham Saad MD | USF Health

Ballard, 3rd Floor

Ensuring Success for Preliminary Surgery Residents

Maki Yamamoto MD | UC Irvine

Cedar, 2nd Floor

Leadership Beyond PD

Daniel Dent MD | UT Health San Antonio

Seneca, 4th Floor

Loss of a Resident

Shaneeta Johnson MD | Morehouse School of Medicine

Kimberly Miller-Hammond MD | Morehouse School of Medicine

Redwood, 2nd Floor

Mastering the Art of Surgery: Teaching the Skills Residents Need to Navigate Crucial Conversations with Colleagues

Anna Newcomb PhD | Inova Fairfax Hospital

Jefferson, 4th Floor

Providing Feedback to Residents with Professionalism Concerns

Betsy Williams PhD, MPH | Professional Renewal Center

Kathleen Zoppi PhD, MPH | Indiana University School of Medicine

Ravenna, 3rd Floor

SAGES Remediation Workshop: Remediation Strategies for the Struggling Resident - Technical Skills and Beyond

Rana Higgins MD | Medical College of Wisconsin

Boren, 4th Floor

SENT/SECOND

Yue-Yung Hu MD, MPH | Lurie's Children's Hospital

Diamond, 1st Floor

Surgical Gladiators: Gamification for Skills Acquisition and Peer Coaching

Pooja Varman MD, MS | Cleveland Clinic

2:00pm - 3:15pm

Grand Ballroom ABC

APDS Paper Session IV - Program Improvements: Making Faculty and Trainees Better

Moderators:

Brian Brewer MD, MBA | HCA Houston Healthcare

Samantha Tarras MD | Indiana University School of Medicine

18. Assessing Surgical Skills Improvement with Video Analysis in Vascular Anastomosis Training

Jorge Sulca Flores BS | Brown University

19. The White Board Time Out Intraoperative Educational Tool Improves Resident Operative Performance

Yeonjoo Cho MD | Maimonides Medical Center

20. Impact of "Parenting in Surgery" Initiative to Address Challenges during Surgical Training

Alyssa Zhou BS | University of California San Francisco

21. Pilot Implementation and Psychometric Analysis of a Multi-Source Resident Leadership Assessment

Roy Phitayakorn MD, MHPE | Mass General Brigham/Massachusetts General Hospital

22. How You Say It Matters: Using Growth Mindset to Improve Faculty Feedback and Resident Motivation

Michael Furey DO, MSMED | Geisinger Wyoming Valley Hospital

23. Surgery Attendings' Autonomy-Supportive and Controlling Coaching Behaviors in the Operating Room

Angela G Atkinson MD | University of Texas Health Science Center San Antonio

3:15pm - 4:15pm

Grand Ballroom ABC

APDS Panel: LLM and NLP (aka AI) - Practical Applications

Moderator(s):

Kari Rosenkranz MD | Dartmouth-Hitchcock/Mary Hitchcock Memorial Hospital Program

Amit Joshi MD | Cooper Medical School of Rowan University/Cooper University Hospital Program

Use of AI tools for Program Recruitment of Prospective Residents

May Tee MD, MPH | Howard University

What Students and Residents Are Doing

David Spain MD | Stanford University

Skills Training / Assessments

Dan Hashimoto MD | University of Pennsylvania

4:15pm - 4:30pm

Grand Ballroom Pre-Function

Afternoon Break

4:30pm - 5:30pm

Grand Ballroom ABC

APDS Paper Session V: Quickshots

Moderators:

Jason Kempenich MD | UT Health San Antonio

Maria Sfakianos MD | Zucker School of Medicine at Hofstra/Northwell

Q1. Challenges Facing Surgical Trainees with Small Hand Size: A Mixed Methods Multi-Institutional Study

Rebecca Tang MD | Mass General Brigham/Massachusetts General Hospital

Q2. Out of Touch: A Nationwide Mixed-Methods e-Learning Needs Assessment of General Surgery Residents

Joshua Roshal MD | University of Texas Medical Branch at Galveston

Q3. Novel Use of ACGME Milestones and Resident Morbidity and Mortality Conference Presentation Feedback

M. Grace McGrath DO | Geisinger Wyoming Valley Hospital

Q4. Intersection of Gender and Time in Practice: Differences in Trainee Evaluations of Surgical Faculty

Manuel Castillo-Angeles MD, MPH | Brigham and Women's Hospital

Q5. Correlation of Personality Testing with Residency Recruitment and PGY-1 Performance

Vincent Yang | University of Texas Medical Branch at Galveston

Q7. Can Preference Signaling Streamline the Applicant Selection Process?

Jeffrey Melvin MD | Boston Medical Center

Q8. EPA Field Analysis: Real-life EPA practice Habits Differ From Expected

Carolyn Chang MD | Oregon Health and Science University

Q6. Understanding How Surgery Applicants Use The “Impactful Experiences” Field In Residency Applications

Jorge Zarate Rodriguez MD | Washington University in St. Louis

5:30pm - 6:00pm

Grand Ballroom ABC

APDS Presentation of Awards

6:00pm - 6:30pm

Grand Ballroom ABC

APDS Membership Meeting

6:30pm - 7:30pm

Grand Ballroom Pre-Function

APDS/ASE Joint Reception

Thursday, May 8

7:00am - 8:00am

Tools of the Trade

Grand Ballroom ABC

Moderators:

John Gahagan MD | Stanford University

T1. The Healthy Minds Program: A Feasible and Scalable Well-being Intervention

Sydney Tan MD | University of Wisconsin

T2. Keeping Duty Hours in Hand: Exploiting Texting to Ensure Compliance

Osama Anis MD | Abington Hospital Jefferson Health

T3. The Impact of a Formalized ABSITE® Remediation Program on Resident Score Improvement

Hannah Holland MD | Medical College of Wisconsin

T4. Overcoming the challenges of EPA: A Tool to Increase the Number of Submissions

Xinyi Luo MD | Tulane University

T5. Worksheet-Based Delivery System to Improve Basic Science - a Multi-Institutional Study

Jocelyn Powell DO | Sinai Hospital of Baltimore

T6. Evaluating the Quality of AI-generated Scenarios for Mock Oral Boards Examinations

Usman Panni MD | Washington University in St. Louis

T7. Creating a Needs Based Curriculum to Support General Surgery Preliminary Residents

Shannon Barter MD | Duke University

T8. A SIMPL Reminder: Program Initiative to Increase EPA Assessment Submissions

Ruth Samson MD | Geisinger Wyoming Valley Hospital

8:00am - 9:10am

APDS Debates in Recruitment

Grand Ballroom ABC

Moderators:

Adham Saad MD | University of South Florida

Loretto Glynn MD | NYU Langone

Signals: Preference and Geographic

They Mean Everything

Michael Ditillo DO | University of Arizona College of Medicine - Tucson Program

They Are Not Worth Anything

Jennifer Cone MD, MHS | University of Chicago

Interviews

In-Person is Best

Audra Clark MD | University of Texas Southwestern

Virtual Only

Rana Higgins MD | Medical College of Wisconsin

Application Services

Sticking with ERAS Best

Britney Corey MD, MACM | University of Alabama at Birmingham

It's Time to Move On

Ronald Cotton MD | Baylor College of Medicine Program

9:00am - 12:00pm

Cirrus Ballroom

Finding Aspiring Students for Tomorrow (FAST) Community Outreach Event

9:10am - 9:30am

Grand Ballroom Pre-Function

Morning Break

9:30am - 10:45am

Grand Ballroom ABC

APDS Keynote Address

Introduction:

Jennifer Choi MD | Indiana University School of Medicine

Leadership in Turbulent Times

Jerome M. Adams MD, MPH | Purdue University

10:45am - 12:00pm

Grand Ballroom ABC

APDS Panel: Faculty - Can't Live With 'Em, Can't Live Without 'Em

Moderators:

Jeffery Dattilo MD | University of Tennessee Nashville

Kristen Conrad-Schnetzer DO | Cleveland Clinic Foundation / South Pointe Hospital Program

Teaching the Faculty: Becoming and Staying a Great Clinical Educator

Grace Kim MD | University of Michigan Health System Program

Getting Them Engaged, Keeping Them Engaged (Academic and Independent Institutions)

Kevin Pei MD, MHS | NYU Langone Health

Passion Tax: Cost of Teaching

Emily Huang MD, MAEd | The Ohio State University Hospital Program

What if They Can't / Don't Teach?

Jason Kempenich MD | UT Health San Antonio

Surgical Education Week 2025



ARAS SCHEDULE



ASSOCIATION of RESIDENCY ADMINISTRATORS in SURGERY

Tuesday, May 6

12:00pm - 12:05pm

Welcome & Introductions

Kylene Smartis C-TAGME | Northeast Georgia Medical Center Program

12:05pm - 12:35pm

How We Do It: Holistic Review of Residency Applications

Lisa Leininger MPH | University of Michigan Health System Program

12:35pm - 1:15pm

Navigating the Transition: Pearls, Pitfalls, and the Balance of Management and Leadership for New Team Leaders

Christa Donald BS | Washington University/B-JH/SLCH Consortium Program

1:15pm - 1:45pm

How to Compose Successful Major Changes for the Annual WebADS Update

Laurie Woldman MBA | NYU Langone Health

1:45pm - 2:30pm

A Culture of Communication

Gary Hodge | St. Mary's Hospital (Waterbury) Program

2:30pm - 2:45pm

Welcome from APDS President

Jennifer Choi MD | Indiana University School of Medicine

2:45pm - 3:00pm

Afternoon Break

3:00pm - 4:15pm

APDS Alphabet Soup (Grand Ballroom ABC)

4:30pm - 5:15pm

Facilitating Change: Implementation Science for Residency Program Administrators in Surgery

Rebecca Williams MD, PhD, MEdPsych | Northwestern University

6:00pm - 7:00pm

APDS & ARAS Reception

Wednesday, May 7

7:00am - 8:00am

Grand Ballroom Pre-Function

Breakfast provided

8:00am - 8:30am

Welcome Day 2 | A Case Study of One Program Administrators Time Allocation

Amanada Royan MEd | MetroHealth

8:30am - 9:15am

PC Superpower - What Can You Do With 5 Minutes?

Elieen Kleffner | University of Texas HSC San Antonio

Teresa Enger | Gundersen Lutheran Medical Foundation Program

9:15am - 10:00am

Thalamus

Ashley Page MHA | Thalamus

10:00am - 10:30am

Leading from the Middle: Leadership Development and Strategies for GME Administrators and Coordinators

Lauren Burr MS | Thomas Jefferson University

10:30am - 10:45am

Morning Break

10:45am - 11:45am

APDS Presidential Address (Grand Ballroom ABC)

Jennifer Choi MD | Indiana University School of Medicine

11:45am - 12:00pm

APDS/ARAS Box Lunch Pick-Up

12:30pm - 1:15pm

From Strategy to Success: Essential Project Management Practices for Program Administrators

Michaela Gombar C-TAGME | University of Wisconsin-Madison

1:15pm - 2:00pm

Navigating Change in Residency and Clerkship Administration: Strategies for Adaptation and Success

Christa Donald BS | Washington University/B-JH/SLCH Consortium Program

Carla Koberna, General Surgery Clerkship Coordinator Washington University

2:00pm - 4:00pm

ABS/ACGME Session

Barbara Gerkins | American Board of Surgery

Chris Fox PhD | ACGME

4:00pm - 4:15pm

Qualtrics: A Key Resource for Education Administrators

Breanna Rose BA, MA | University of Virginia

Heather Trainum | University of Virginia

4:15pm - 4:30pm

Afternoon Break

4:30pm - 5:30pm

EPAs

Karen Brasel MD, MPH | American Board of Surgery

5:30pm - 6:00pm

APDS Presentation of Awards (Grand Ballroom ABC)

6:00pm - 6:30pm

APDS Membership Meeting (Grand Ballroom ABC)

6:30pm - 7:30pm

APDS/ARAS/ASE Joint Reception

Thursday, May 8

6:30am - 7:00am

APDS/ARAS Breakfast

7:00am - 8:00am

Tools of the Trade

ARAS Sessions will be held in Grand Ballroom D unless otherwise noted

8:30am - 9:00am

ACS ERRA

ACS SRRA

Patrice Gabler Blair, DrPH, MPH

ACS Fundamentals of Surgery and Cognitive Simulation Curricula

Patricia Numann MD, FACS

9:00am - 9:10am

TAGME

Kahoot Quiz

Mary Ann Garcia-Bowerman MBA, C-TAGME | Emory University School of Medicine Program

9:10am - 9:30am

Morning Break

9:30am - 10:45am

APDS Keynote Address (Grand Ballroom ABC)

10:45am - 11:30am

ISO (In Search of)

Amanada Royan MEd | MetroHealth

11:30am - 11:45am

Introduction of 2025/2026 Executive Committee

Surgical Education Week 2025



ASE SCHEDULE



For a more detailed agenda, visit our [meeting site](#) or download the [Event Pilot app](#)

Wednesday, May 7, 2025

Everett | 3rd Floor
Nursing Room

Fremont | 3rd Floor
Quiet Zone

6:30 AM – 5:30 PM | 6:30 PM – 7:30 PM
Grand Ballroom Pre-Function | 2nd Floor
ASE Registration

5:30 AM – 4:00 PM
Capitol Hill | 3rd Floor
Speaker Ready Room

9:00 AM – 4:00 PM | 6:30 PM – 7:30 PM
Grand Ballroom Pre-Function | 2nd Floor
SEW Exhibitors

7:30 AM – 5:00 PM
Metropolitan Ballroom A | 3rd Floor
The Surgical Education Research Fellowship Program (SERF)
**Invitation Only*

8:00 AM – 11:00 AM
Issaquah Room | 3rd Floor
The Surgical Education and Leadership Fellowship (SELF) Session
**Invitation Only*

9:00 AM – 5:00 PM
Aspen Room | 2nd Floor
Trainee Lounge/Future Leaders Learning Center

4:00 PM – 4:30 PM
Issaquah Room | 3rd Floor
The Surgical Education and Leadership Fellowship (SELF) Wrap Up
**Invitation Only*

PRE-MEETING COURSES | **Separate Registration Required*

7:00 AM – 4:30 PM
Metropolitan Ballroom B | 3rd Floor
Updates on the Surgery Clerkship

8:00 AM – 12:00 PM
Greenwood Room | 3rd Floor
Fundamentals of a Career in Surgical Education (FACSE): Pathway to Clinician Educator

8:00 AM – 2:15 PM
Leschi Room | 3rd Floor
Vice Chair of Education Career Development Workshop

12:00 PM – 4:00 PM
Issaquah Room | 3rd Floor
Fundamentals of Teaching

1:00 PM – 5:00 PM

Greenwood Room | 3rd Floor

Simulation-Based Practices for Teaching Coaching, Mentorship, and Leadership Skills to Surgeon Educators

5:00 PM – 6:30 PM

Ravenna ABC | 3rd Floor

ASE Trainee Speed Mentoring Event

**Pre-Registration Required*

6:30 PM – 7:30 PM

Grand Ballroom Pre-Function | 2nd Floor

ASE/APDS Joint Reception

Thursday, May 8, 2025

Everett | 3rd Floor

Nursing Room

Fremont | 3rd Floor

Quiet Zone

6:30 AM – 6:30 PM

Grand Ballroom Pre-Function | 2nd Floor

ASE Registration

8:00 AM – 6:00 PM

Capitol Hill | 3rd Floor

Speaker Ready Room

7:00 AM – 10:00 AM

Jefferson, University & Virginia Rooms | 4th Floor Union Street Tower

Concurrent Committee Meetings

8:00 AM – 3:00 PM

Ballard Room | 3rd Floor

Clerkship Coordinator Track Program

**Registration for Clerkship Coordinator/SEW Coordinator Track Required*

8:40 AM – 11:30 AM

Leschi, Medina & Kirkland Rooms | 3rd Floor

The Surgical Education Research Fellowship Program (SERF)

**Invitation Only*

9:00 AM – 4:00 PM

Grand Ballroom Pre-Function | 2nd Floor

SEW Exhibitors

9:00 AM – 5:00 PM

Aspen Room | 2nd Floor

Trainee Lounge/Future Leaders Learning Center

9:00 AM – 12:00 PM

Cirrus Ballroom | 35th Floor Pike Street Tower

APDS/ASE Finding Aspiring Surgeons for Tomorrow (FAST Community Outreach Event)

9:00 AM – 1:00 PM

Issaquah Room | 3rd Floor

The Surgical Education and Leadership Fellowship (SELF)

**Invitation Only*

11:00 AM – 12:00 PM
Ravenna ABC | 3rd Floor

Shark Tank, Presented by the Surgical Education Research Committee (SERC)

12:00 PM – 12:20 PM
Grand Ballroom ABC | 2nd Floor

Welcome Remarks

12:20 PM – 1:50 PM
Grand Ballroom ABC | 2nd Floor

APDS/ASE Joint Panel – Nurturing Surgical Families to Build a More Inclusive Surgical Workplace

1:00 PM – 5:00 PM
Diamond A&B | 1st Floor

Surgical Fellowships: Challenges and Opportunities Workshop

1:55 PM – 2:55 PM
Grand Ballroom ABC | 2nd Floor

J. Roland Folsie Invited Lecture

Speaker: Patricia Numann, MD

Introduction by: Mohsen Shabahang, MD, PhD, MAMSE

Topic: Achieving Equity

2:55 PM – 3:20 PM
Grand Ballroom Foyer | 2nd Floor

Break

3:20 PM – 4:20 PM
Grand Ballroom ABC | 2nd Floor

Plenary Session

4:25 PM – 5:25 PM
Grand Ballroom ABC | 2nd Floor

Panel I – Getting EPAs up and Running: Troubleshooting your EPA Implementation

5:25 PM – 5:30 PM
Grand Ballroom ABC | 2nd Floor

ASE Day 1 – Closing Remarks

5:00 PM – 5:30 PM
Issaquah Room | 3rd Floor

SELF Alumni Social

**Invitation Only*

5:30 PM – 7:00 PM
Issaquah Room | 3rd Floor

SELF Wrap Up Reception and Forum

Open to All Attendees

5:35 PM – 6:35PM
2nd Floor

Poster Sessions

Poster Session I Assessment | Redwood A

Poster Session II Curriculum Development | Redwood B

Poster Session III Simulation | Willow A

Poster Session IV Recruitment & Selection / Other | Willow B

Poster Session V Faculty Development & Leadership | Cedar A&B

6:40 PM – 8:00 PM
Ravenna ABC | 3rd Floor
Candlelight Session

Friday, May 9, 2025

Everett | 3rd Floor
Nursing Room

Fremont | 3rd Floor
Quiet Zone

6:45 AM – 6:30 PM
Grand Ballroom Pre-Function
ASE Registration

7:00 AM – 5:45 PM
Capitol Hill | 3rd Floor
Speaker Ready Room

7:00 AM – 8:00 AM
Jefferson, University & Virginia Rooms | 4th Floor Union Street Tower
Concurrent Committee Meetings

7:30 AM – 8:00 AM
Grand Ballroom Pre-Function | 2nd Floor
Morning Refreshments: Open to all SEW & ASE attendees

9:00 AM – 3:00 PM
Diamond A&B | 1st Floor
Clerkship Coordinator Track Program
**Registration for Clerkship Coordinator/SEW Coordinator Track Required*

8:00 AM – 8:10 AM
Grand Ballroom ABC | 2nd Floor
Day 2 Welcome Remarks

8:10 AM – 9:10 AM
Grand Ballroom ABC | 2nd Floor
Presidential Address
Speaker: Mohsen Shabahang, MD, PhD, MAMSE
Topic: Empowerment, Acknowledgment, Inclusion in Surgical Education

9:00 AM – 1:00 PM
Grand Ballroom Pre-Function | 2nd Floor
SEW Exhibitors

9:00 AM – 5:00 PM
Aspen Room | 2nd Floor
Trainee Lounge/Future Leaders Learning Center

9:15 AM – 10:15 AM
Grand Ballroom ABC | 2nd Floor
Panel II – Career Transitions: New Missions for Senior Surgeons and Educators as Role Models and Leaders

10:15 AM – 10:45 AM
Grand Ballroom Foyer | 2nd Floor
Break

10:15 AM – 10:45 AM
Grand Ballroom Foyer | 2nd Floor
2025 ATLAS Competition

10:45 AM – 12:00 PM
Podium Sessions
Podium Session I A Assessment | Redwood A&B | 2nd Floor
Podium Session I B Education Technology | Cedar A&B | 2nd Floor
Podium Session I C DEI | Willow A&B | 2nd Floor

12:00 PM – 1:00 PM
Grand Ballroom D | 2nd Floor
Thinking Out of the Box Session

12:25 PM – 12:55 PM
Grand Ballroom ABC | 2nd Floor
Keynote Lecture
Speaker: Olle Ten Cate, PhD
Topic: Entrustable Professional Activities in Surgery: The Rationale, the Challenges, and the Opportunities

1:00 PM – 2:00 PM
Grand Ballroom ABC | 2nd Floor
Royce Laycock Guest Lecture
Speaker: Amer Kaissi, PhD
Introduction by: Nabil Issa, MD
Topic: Humbitious Leadership in Times of Change: How to Connect with Humility & Elevate with Ambition

1:00 PM – 4:30 PM
University & Seneca Rooms | 4th Floor Union Street Tower
The Surgical Education Research Fellowship Program (SERF) Forum

2:05 PM – 3:05 PM
Podium Sessions
Podium Session II A Wellness / Other | Redwood A&B | 2nd Floor
Podium Session II B Global Surgical Education | Cedar A&B | 2nd Floor
Podium Session II C Faculty Development | Willow A&B | 2nd Floor

3:00 PM – 3:30 PM
Grand Ballroom Foyer | 2nd Floor
Break

Workshops

3:30 PM - 5:00 PM | Grand Ballroom D | 2nd Floor
Workshop 1: The Underperforming Faculty Member

3:30 PM - 5:00 PM | Willow A&B | 2nd Floor
Workshop 2: Leveraging AI for Research: Transforming Ideas into Scholarly Publications

3:30 PM - 5:00 PM | Ravenna ABC | 3rd Floor
Workshop 3: Implementing a Cultural Dexterity Curriculum in Surgical Residencies

3:30 PM - 5:00 PM | Issaquah | 3rd Floor
Workshop 4: New and Early Career Simulation Educators: How to Start and Continue to Grow a Simulation Program

3:30 PM - 4:15 PM | Ballard | 3rd Floor
Workshop 5: Mitigating Bias in Resident and Medical Student Recruitment

3:30 PM - 4:15 PM | Leschi | 3rd Floor

Workshop 6: Challenges with Professional Identity Among Faculty of Independent Academic Medical Centers

4:20 PM - 5:05 PM | Ballard | 3rd Floor

Workshop 7: Fostering Growth Mindsets in Surgical Trainees: The Educator's Toolkit

4:20 PM - 5:05 PM | Leschi | 3rd Floor

Workshop 8: Fundamentals of Communication in Surgery

5:10 PM – 6:10 PM

Podium Sessions

Podium Session III A Curriculum Development | Redwood A&B | 2nd Floor

Podium Session III B Recruitment Selection | Cedar A&B | 2nd Floor

Podium Session III C Potpourri | Willow A&B | 2nd Floor

6:15 PM – 7:00 PM

Metropolitan Ballroom Foyer | 3rd Floor

Pre-Banquet Reception

7:00 PM – 9:00 PM

Metropolitan Ballroom | 3rd Floor

Awards Banquet - Ticketed Event

Saturday, May 10, 2025

Everett | 3rd Floor

Nursing Room

Fremont | 3rd Floor

Quiet Zone

6:45 AM – 11:00 AM

Grand Ballroom Pre-Function

ASE Registration

7:00 AM – 11:30 AM

Capitol Hill | 3rd Floor

Speaker Ready Room

7:00 AM – 8:00 AM

Jefferson, University & Virginia Rooms | 4th Floor Union Street Tower

Concurrent Committee Meetings

7:30 AM – 8:00 AM

Grand Ballroom Pre-Function | 2nd Floor

Morning Refreshments: Open to all SEW & ASE attendees

8:00 AM – 11:45 AM

Ballard Room | 3rd Floor

Clerkship Coordinator Track Program

**Registration for Clerkship Coordinator/SEW Coordinator Track Required*

8:00 AM – 8:10 AM

Grand Ballroom ABC | 2nd Floor

Day 3 Welcome Remarks

8:10 AM – 9:10 AM

Grand Ballroom ABC | 2nd Floor

Panel III – Cutting Through the Controversy: Great Debates in Surgical Education

9:15 AM – 10:15 AM

Grand Ballroom ABC | 2nd Floor

Panel IV – Global Perspectives on Simulation in Surgical Education: From DIY to Advanced Training

10:15 AM – 10:45 AM

Grand Ballroom Foyer | 2nd Floor

Break

10:45 AM – 11:45 AM

Grand Ballroom ABC | 2nd Floor

Panel V – Teaching Green: Integrating Environmental Responsibility into Surgical Training

11:50 AM – 12:05 PM

Grand Ballroom ABC | 2nd Floor

Closing Remarks & Award Announcements

2026 Surgical Education Week

Atlanta Marriott Marquis

April 28 – May 2, 2026

